

Square brass rod for free machining

Product denomination: SQUARE ROD UNI EN 12164

Condition of material: M

Tolerance class: n.a.

Reference European norm: UNI EN 12164

Available measures: from key 10 mm to key 24 mm
configurable on request

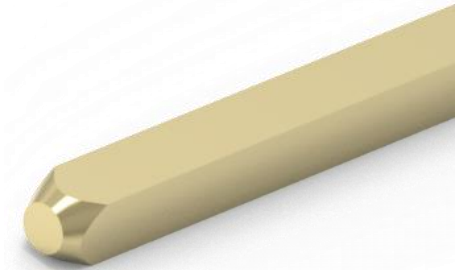

Dimensions, straightness and tolerances

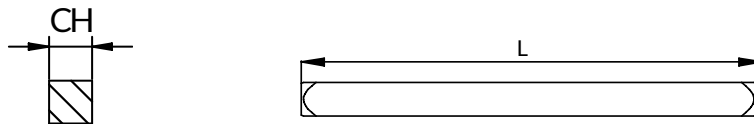

Key - CH (mm)		Key tolerance (mm)	Length - L (mm)	Length tolerance (mm)
From	To and included			
n.a.	10	+0 -0,09	3000	± 50
10	18	+0 -0,11	3000	± 50
18	24	+0 -0,13	3000	± 50

Key (mm)		Edge spoke	
From	To and included	Sharp edges (mm)	Rounded edges (mm)
(and included) 10	18	0,5	0,5 -1,2
18	24	0,6	0,6 - 1,8

Key (mm)		Maximum deviation from straightness - F (mm)	
From	To and included	Every 400 mm	Every m of length L ≥ 1 m
(and included) 10	24	0,6	1,5 x L (m)



GHIDINI TRAFILERIE

Finishing, surface and packaging

End finishing	Ends with tip and chamfer or configurable on request
Surface condition	Pickled
Packaging	Bundles weighing 1000 ± 100 kg tied with metal straps and, as applicable or requested, packed with Polyethylene Film
Identification	Adhesive label

Details of tip and chamfer

Key (mm)		Tip - A	Chamfer - B
From	To and included	Length - L (mm)	Length - L (mm)
(and included) 10	20	2 - 6	0,5 - 2
20	24	3 - 10	0,5 - 3

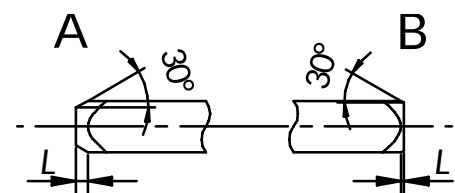

Available alloys

- CW614N (base alloy)
- CW617N
- CW603N
- CW510L

Ghidini Trafilerie S.p.A. - Via Cav. Faustino Ghidini, 8 - 25065 Lumezzane (BS) Italy
 Telefono: +39 030 871461 - Fax: +39 030 871998 - E-mail: info@ghidinitrafilerie.com
 P. IVA 02033500980 - Registro Imprese di Brescia n. iscriz. e Cod. Fisc. 01834980177
 Capitale Sociale € 16.000.000 i.v. - Website <https://www.ghidinitrafilerie.com>